

MODULAR BELTS

ZY-900FT FLAT TOP MODULAR BELTS

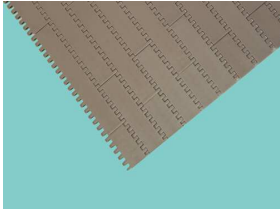

Mat.:POM/PP
 Pin mat.:PP/PA
 Color:Blue/white/brown
 Open area:0%
 Working load:
 POM-18000N/M;PP-9000N/M

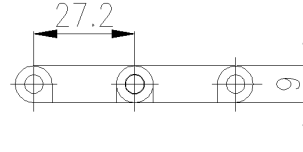

The belt standard width starts from 6" with 2" increments up to 120",special increments 8.4mm is available

ZY-900PT PERFORATED MODULAR BELTS

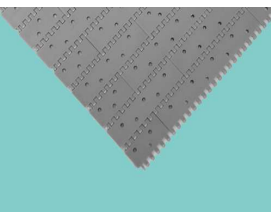

Mat.:POM/PP
 Pin mat.:PP/PA
 Color:Blue/white/brown
 Open area:6.7%
 Working load:
 POM-18000N/M;PP-9000N/M

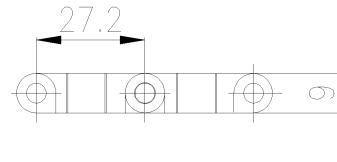

The belt standard width starts from 6" with 2" increments up to 120",special increments 8.4mm is available

ZY-900FTR-1 FLAT TOP MODULAR BELTS WITH RUBBER FRICTION TOP

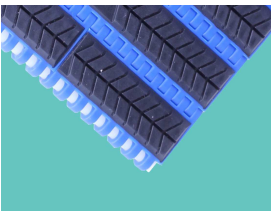

Mat.:POM with rubber inserts
 Pin mat.:PP/PA
 Color:Blue with black rubber
 Open area:0%
 Working load:
 POM-18000N/M;PP-9000N/M

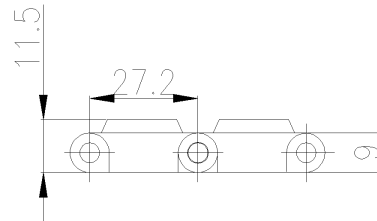

The belt standard width starts from 6" with 2" increments up to 120",special increments 8.4mm is available

ZY-900FTR-2 FLAT TOP MODULAR BELTS WITH RUBBER FRICTION TOP

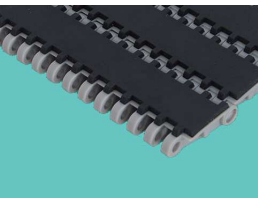

Mat.:POM with rubber inserts
 Pin mat.:PP/PA
 Color:Blue with black rubber
 Open area:0%
 Working load:
 POM-18000N/M;PP-9000N/M

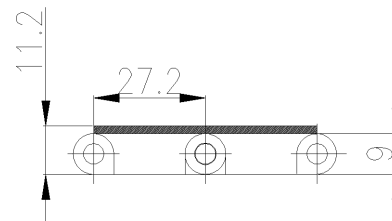

The belt standard width starts from 6" with 2" increments up to 120",special increments 8.4mm is available

ZY-900RR RAISED RIB MODULAR BELTS

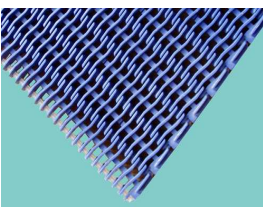

Mat.:POM/PP
 Pin mat.:PP/PA
 Color:Blue/white/brown
 Open area:38%
 Working load:
 POM-18000N/M;PP-9000N/M

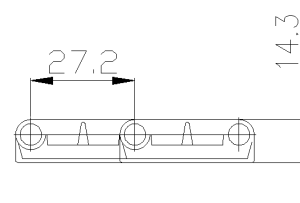

The belt standard width starts from 6" with 2" increments up to 120",special increments 8.4mm is available

MODULAR BELTS

ZY-900FG FLUSH GRID MODULAR BELTS

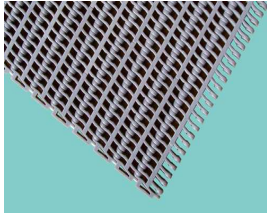

Mat.:POM/PP
 Pin mat.:PP/PA
 Color:Blue/white/brown
 Open area:38%
 Working load:
 POM-18000N/M;PP-9000N/M

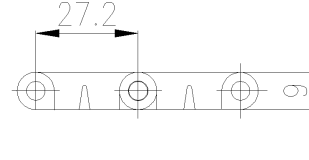

The belt standard width starts from 6" with 2" increments up to 120", special increments 8.4mm is available

ZY-900-RR MOLD TO WIDTH RAISED RIB MODULAR BELTS

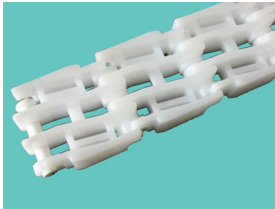

Mat.:POM/PP Pin mat.:PP/PA
 Color:Blue/white
 Open area:38%
 Working load:
 POM-18000N/M;PP-9000N/M
 Width:29mm 37mm 46mm

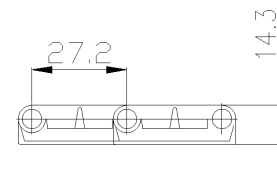

ZY-900FG LIVE TRANSFER FLUSH GRID MODULAR BELTS

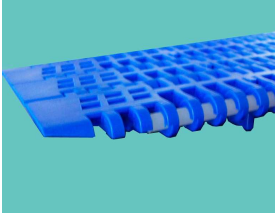

Mat.:POM/PP Pin mat.:PP/PA
 Color:Blue/white
 Open area:38%
 Working load:
 POM-18000N/M;PP-9000N/M

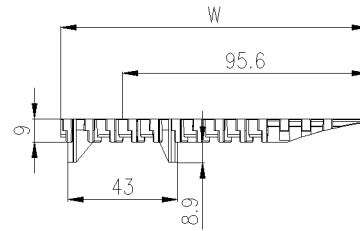

The belt standard width starts from 170mm, with 8.4mm increments

ZY-900-RR-FT FINGER PLATES

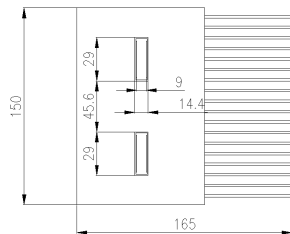
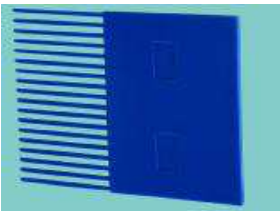

Mat.:POM; Color: blue/white

ZY-900FT/ZY-900FG FLIGHTS



Height:25mm/50mm
 Mat.:POM/PP
 Color:white

SPROCKETS FOR ZY-900FT/ZY-900PT/ZY-900FTR-1/ZY-900FTR-2/ZY-900RR/ZY-900FG

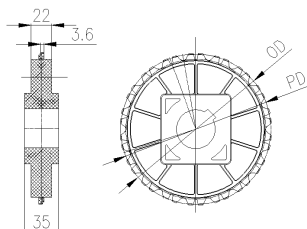

Nb of teeth	P D	O D	Bore
	mm	mm	mm
6	54.4	53	○/ □ min. 25
9	79.5	81	
12	105.0	109	○/ □ max. 40
18	156.6	160	