

LC210系列按键开关

技术参数 SPECIFICATION:

安规认证 (safety approval) :UL, CUL, VDE, ENEC
 电气规格 (Electrical rating) :10A/12A 250VAC, 12A125VAC
 机械寿命 (Mechanical life endurance) :30000 cycles
 电器寿命 (Electrical life endurance) :10000 cycles
 接触电阻 (Contact resistance) :<20mΩ
 绝缘电阻 (Insulation resistance) :>1000MΩ
 环境温度 (Ambient temperature) :>T85/T105
 防火等级 (Flammability) :UL94 V-2, UL94 V-0.灼热丝, 针焰测试
 外壳材料 (Material of housing) :PA66/PC
 触电材料 (Contacts) :银合金 (Silver alloy)
 端子材料 (Terminal) :铜镀镍 (Copper silver plated)
 端子焊性 (Solder ability of terminal) :Max 350°C 3S, 用手焊接时, 不可给端子施加压力



料号 Ordering Procedure

LC210	1	K	K	E	T	0	B																																														
SERIES	SWITCH FUNCTION	HOUSING COLOR	ACTUATOR COLOR	MARKING	TERMINAL TYPE	LAMP VOLTAGE	SAFETY APPROVAL																																														
Series	<table border="1"> <tr><td>1</td><td>ON-OFF</td></tr> <tr><td>2</td><td>(ON)-OFF</td></tr> <tr><td>5</td><td>ON-OFF</td></tr> <tr><td>6</td><td>(ON)-OFF</td></tr> <tr><td>7</td><td>ON-OFF(with lamp)</td></tr> <tr><td>8</td><td>(ON)-OFF(with lamp)</td></tr> </table>	1	ON-OFF	2	(ON)-OFF	5	ON-OFF	6	(ON)-OFF	7	ON-OFF(with lamp)	8	(ON)-OFF(with lamp)	<table border="1"> <tr><td>W</td><td>White</td></tr> <tr><td>K</td><td>Black</td></tr> </table>	W	White	K	Black	<table border="1"> <tr><td>W</td><td>White</td></tr> <tr><td>K</td><td>Black</td></tr> <tr><td>R</td><td>Red</td></tr> <tr><td>Y</td><td>Yellow(illu)</td></tr> <tr><td>M</td><td>Green(illu)</td></tr> <tr><td>D</td><td>Red(illu)</td></tr> </table>	W	White	K	Black	R	Red	Y	Yellow(illu)	M	Green(illu)	D	Red(illu)	<table border="1"> <tr><td>E</td><td>No Marking</td></tr> </table>	E	No Marking	<table border="1"> <tr><td>T</td><td>Quick connect tab type</td></tr> </table>	T	Quick connect tab type	<table border="1"> <tr><td>0</td><td>No lamp</td></tr> <tr><td>1</td><td>125V AC</td></tr> <tr><td>2</td><td>250V AC</td></tr> <tr><td>3</td><td>12V DC</td></tr> <tr><td>4</td><td>24V DC</td></tr> </table>	0	No lamp	1	125V AC	2	250V AC	3	12V DC	4	24V DC	<table border="1"> <tr><td>F</td><td>5 Safety Approvals</td></tr> <tr><td>B</td><td>JL,CUL,CQC</td></tr> </table>	F	5 Safety Approvals	B	JL,CUL,CQC
1	ON-OFF																																																				
2	(ON)-OFF																																																				
5	ON-OFF																																																				
6	(ON)-OFF																																																				
7	ON-OFF(with lamp)																																																				
8	(ON)-OFF(with lamp)																																																				
W	White																																																				
K	Black																																																				
W	White																																																				
K	Black																																																				
R	Red																																																				
Y	Yellow(illu)																																																				
M	Green(illu)																																																				
D	Red(illu)																																																				
E	No Marking																																																				
T	Quick connect tab type																																																				
0	No lamp																																																				
1	125V AC																																																				
2	250V AC																																																				
3	12V DC																																																				
4	24V DC																																																				
F	5 Safety Approvals																																																				
B	JL,CUL,CQC																																																				

开关功能 Option Of Switch Function

Item No	POLES & THROWS	Rocker position () : Momentary		
		Down	Center	Up
Lc2101	SPST	ON	None	OFF
Lc2102	SPST	(ON)	None	OFF
Lc2103	SPST(with lamp)	ON	None	OFF
Lc2104	SPST(with lamp)	(ON)	None	OFF
Lc2105	DPST	ON	None	OFF
Lc2106	DPST	(ON)	None	OFF
Lc2107	DPST(with lamp)	ON	None	OFF
Lc2108	DPST(with lamp)	(ON)	None	OFF

外形尺寸 Dimension

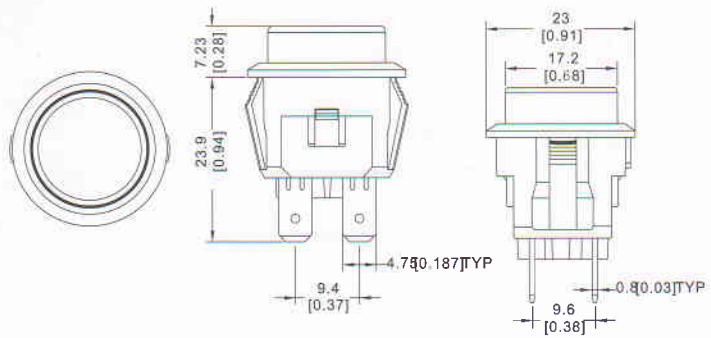

开孔尺寸 Panel Cut Out

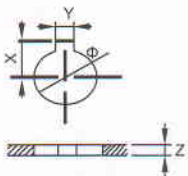

PANEL CUT OUT			
Z	Y	X	Ø
0.7~1.25	2	11	Ø20.5
1.25~2.0	2	11	Ø20.5
2.0~3.0	2	11	Ø20.5

