

Isolation Switch

Application

Isolating Switch is used as main switch for household and similar installation.

Technical Specification

Item	WGK02	GK08
Poles	1P, 2P, 3P, 4P	1P, 2P, 3P, 4P
Rated voltage(Ue)	230V/400V	230V/400V
Rated current(Ie)	25A, 40A, 63A, 80A, 100A	25A, 40A, 63A, 80A
Rated category	AC-22A	AC-22A
Rated impulse withstand voltage(Uimp)	6KV	6KV
Protection class	IP20	IP20
Standard	60947-3	60947-3

Configuration and Mounting Dimensions

WGK02-100 1P

WGK02-100 3P

GK08 2P

GK08 4P

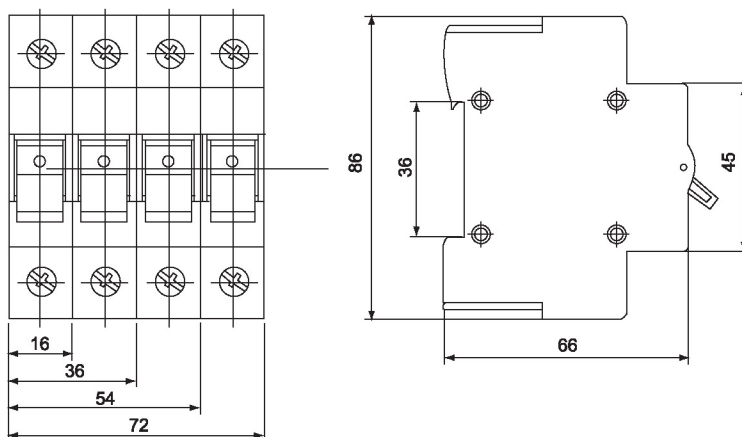

WGK02

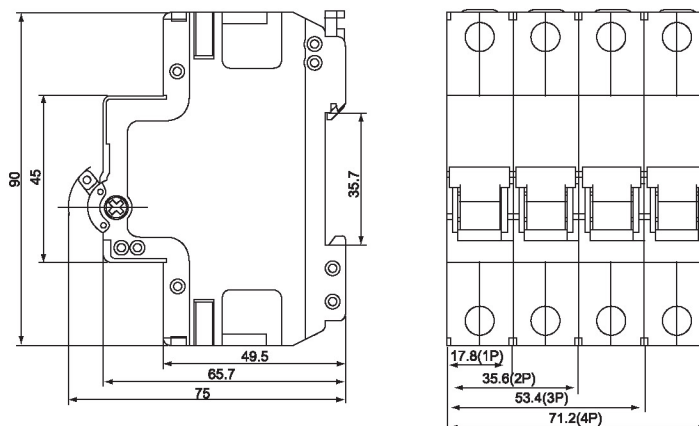

GK08