

High-energy Efficiency AC Contactor (GC2 Series)

Energy
Efficiency
Grade A

CHINA ENERGY LABEL

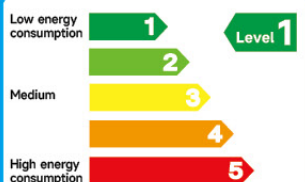

High-energy Efficiency

Noise-Free

Long Service-Life

Anti-Voltage Sag

Wide Voltage

GC2 Series AC Contactor (GC2-4011)

CJX2 Series AC Contactor (CJX2-4011)

✓ Holding Current **15.9(mA)**

✗ Holding Current **122(mA)**

✓ Holding Power **3.5 (V.A)**

✗ Holding Power **26.8 (V.A)**

✓ Energy Consumption
24.5(KWH)/Year

✗ Energy Consumption
187.6(KWH)/Year

VS

Note: The consumption data refers to the device working for 7000hours/year

Introduction

GC2 series High-energy Efficiency AC Contactor is suitable for AC 50hz or 60hz, the voltage up to 690V, the rated operational current up to 120A, which is used as remote power or manual switch for circuit control and also can be directly installed with the thermal relay, composed of electromagnetic starter, to protect overload circuit, frequently to start or stop of AC motor. The product meets Energy Efficiency Grade A and is produced according to IEC60947-4-1, GB14048.4-2020, GB 21518-2022.

High-energy Efficiency AC Contactor (GC2 Series)



Features

GC2 series High-energy Efficiency AC Contactor only adjusts the parameters of the coil, and then matches to the energy-saving module, without any changes on structure and function of the traditional contactor and the collocation of all accessories to achieve the purpose of high energy-saving featured with high voltage suction and low voltage maintenance. It's easy that only to install the high energy saving coil module on normal AC contactors to become GC2 series.

1. Energy-savings: under the holding state with the working voltage 220V AC, the maximum holding current of this product is only 15.9mA, holding power is 3.5 (V.A), slightly lower than the standards-GB 21518-2022 specified Energy Efficiency class A of 4.5 (V.A). Compared to normal AC contactor-CJX2-4011 under the same holding state, whose working current is 122mA, holding power is 26.8 (V.A), so the power consumption of normal AC contactors is more than 7 times that of GC2 series energy-saving AC contactors. And the GC2 series AC contactor can save more than 160KWH/year according to the service life of 7000 hours/year.

2. Wide Holding Voltage, Anti-Voltage Sag: the minimum suction voltage of the product's coil is 150V, and its lowest holding voltage is 90V, which means its Sag voltage is not less than 90V. Also is available to customized with the delay function of 1~ 3s in special occasions.

3. Low-temperature Rise, Noise-free : the working principle of the product's coil is high voltage suction, low voltage maintenance. Its holding voltage is only 18V under the working state of 220V voltage, and no noise caused by strong coil suction with low temperature rise to make long service life.

Type Designation

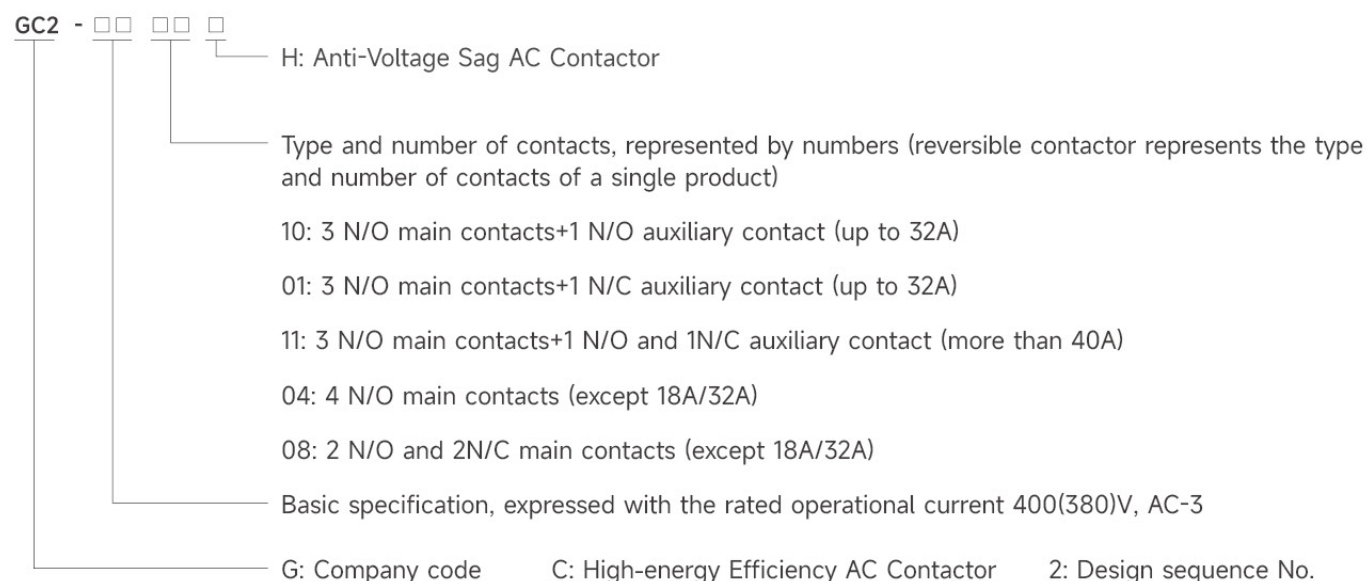

High-energy Efficiency AC Contactor (GC2 Series)



Technical Data

Model			GC2-09	GC2-12	GC2-18	GC2-25	GC2-32	GC2-40	GC2-50	GC2-65	GC2-80	GC2-95
Rated operational current (A)	380/400V	AC-3	9	12	18	25	32	40	50	65	80	95
		AC-4	3.5	5	7.7	8.5	12	18.5	24	28	37	44
	660/690V	AC-3	6.6	8.9	12	18	21	34	39	42	49	49
		AC-4	1.5	2	3.8	4.4	7.5	0	12	14	17.3	21.3
Conventional thermal current(A)			20	20	32	40	50	60	80	80	95	95
Rated insulation voltage(V)			690	690	690	690	690	690	690	690	690	690
Power of controlled 3-phase cage motor		220/230V	2.2	9	4	5.5	7.5	3	15	18.5	22	25
		380/400V	4	5.5	7.5	11	15	18.5	22	30	37	45
		660/690V	5.5	7.5	10	15	18.5	30	37	37	45	45
Coil power (VA)	Suction	AC-3	76	76	76	110	110	230	230	230	230	230
	Holding	AC-4	10	10	10	3.5	3.5	3.5	3.5	3.5	3.5	3.5
Electric durabilities (×10 ⁴ cycles)	AC-3		100	100	100	100	80	80	60	60	60	60
	AC-4		20	20	20	20	20	15	15	15	10	10
Mechanical durabilities (×10 ⁴ cycles)			1000	1000	1000	1000	800	800	800	800	600	600

High-energy Efficiency AC Contactor (GC2 Series)



Dimensions

GC2-09~32

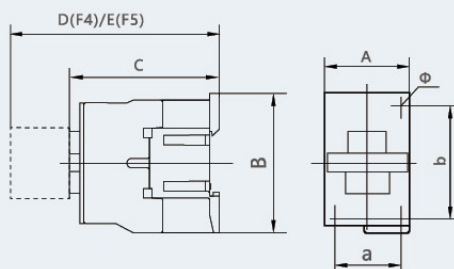

GC2-40~95

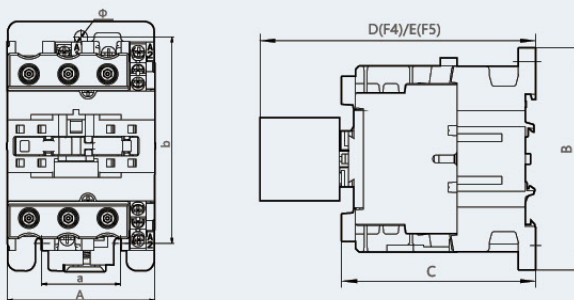

unit: mm

Model	A max	B max	C max	D max	E max	a	b	Φ
GC2-09~12	47	76	82	120.5	140.5	34/35	50/60	4.5
GC2-18	47	76	87	125.5	145.5	34/35	50/60	4.5
GC2-25	57	86	95	133.5	153.5	40	48	4.5
GC2-32	57	86	100	138.5	158.5	40	48	4.5
GC2-4011~6511	77	129	140	178.5	194.5	40	105	6.5
GC2-4004~6504	84	129	140	178.5	194.5	40	105	6.5
GC2-4008~6508	84	129	151	178.5	194.5	40	105	6.5
GC2-8011~9511	87	129	151	184.5	200.5	40	105	6.5
GC2-8004~9504	96	129	146	184.5	200.5	40	105	6.5
GC2-8008~9508	96	129	146	184.5	200.5	40	105	6.5

WENZHOU GUANGYUAN ELECTRIC CO. LTD.

ADD: No. 10 Huancheng East Road,
Houjie Ind. Z., Liushi, Wenzhou, China
TEL : 86+577-62772810 62782810

FAX : 86+577-62775810
E-MAIL : light@rgs.cn
WEB : www.RGS.cn

