

Product Description

Features

- Extensive coverage for both car and truck makers, all-in-one solution which meets all your diagnostic requirements.
- Support basic diagnostic functions like Read Version Information, Read DTC, Clear DTC, Data Stream, Actuation Test, etc and also setting, coding and programming for cars & trucks.
- Support Online DTC Query, online dictionary, data manager and data sharing, quick remote diagnosis.
- Support data reference value mode, professional waveform display, instrument DIY function, and data stream analysis.
- Support one key update/ logging/ quick test/ test report/ feedback functions.
- Full comprehensive diagnostic function, specific diagnostic coverage for Heavy Duty truck and passenger cars.
- Support multiple language, more than 22 languages all over the world.
- Support UDS, ISO 91412, K/L lines, SAE- J1850, CAN ISO 11898 ISO 15765-4, High speed, Middlespeed, low speed and Single wire CAN, SAE- J1939, SAEJ1 708, SAEJ- 1587.
- Support car and truck connectors and cables.
- Bluetooth internet capability allows for wireless access throughout the workshop.
- Hardware architecture uses a new design with multiple protection, interference and stability. Built-in overvoltage protection module is applied, in order to protect scanner and vehicle against accidental damage during checking.
- Can work stably in high and low temperature environment.

Tablet Specifications

System	Base on Android 7.1 multi-tasking and multi-language operating system
Dimension	280*185*26.5mm
Display	10.1" resolution: 800*1280/1200*1920
CPU speed	A72: 2GHz, A53: 1.4GHz
RAM	2GB compatible
ROM Flash	32GB
Speaker	Tereo Built-in 8Ω/ 1W *2 speaker (waterproof)
CPU type	RK3399 (ARM quad-core A53+dual-core A72)
Battery	Polymer lithium ion battery; 3.7V/ 10000mAh detachable; battery life: 6+/H
Sensor	3-axis rotation
Touchscreen	Capacitive screen
Docking	Supports Docking extensions

Connection	WIFI (802.11 ac/b/g/n) & Bluetooth 4.0
Camera	Front and rear double shot, front 2MP / rear 5MP
Interface	HDMI, USB3.0, USB2.0, TF card slot (expandable to 128G), headphone jack, DC interface, COM port
VCI Specifications	
Processor	ARM 32-bit Cortex processor
Communications	802.11 b/g Wireless LAN
Input Voltage	DC 8-28V
Operating Temperature	-10 to 70 °C (14-158°), FRelative Humidity:<90%
Storage Temperature	-30 to 120°C (-22 to 248°F), Relative Humidity:<90%
Communication model	Bluetooth or USB
Protocols	UDS, ISO 9141-2, K/L lines, SAE-J1850 VPW, SAE-J1850 PWM, CAN ISO 11898 ISO 15765-4, High speed, Middle speed low speed and Single wire CAN, SAE-J1939, SAE-J1708, SAE-J1587

APP Guide

- At first, please keep network working. Run IDUTEX APP, then click " Update " to get applications.

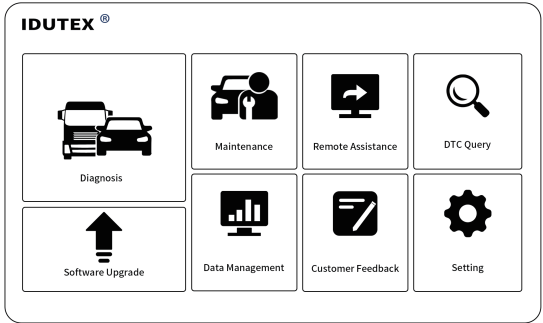

• Please input the hardware S/N number and password and then press "Login".

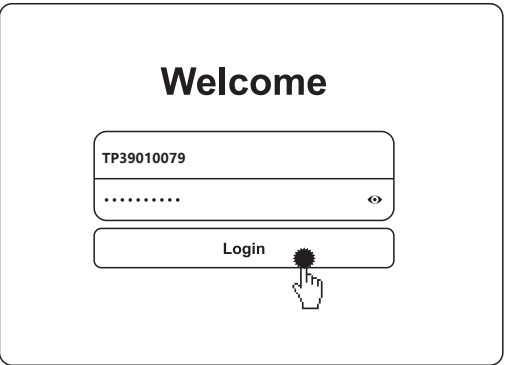

Kindly Remind: The S/N and password asked above can be found in an envelope marked by "S/N:" characters

• If the product is not activated, please press "OK".

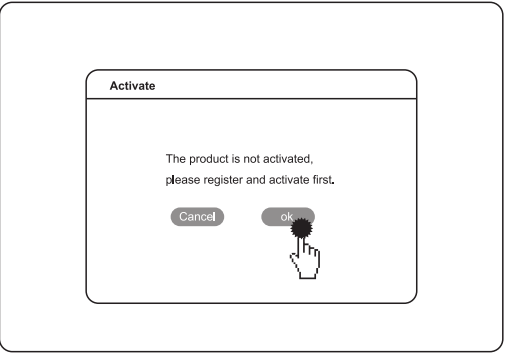

• Please input your information, the email address and country is required, and then press "Activate".

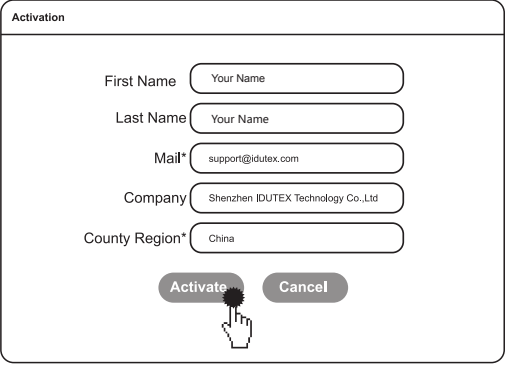

• After the information has been committed, please log in your email to activate the product.

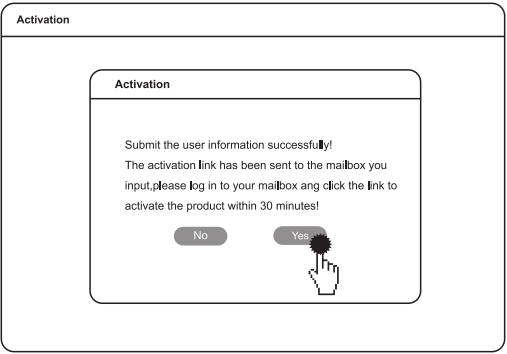

• You will receive a activated email from the IDUTEX server.

Dear Customer,

Please click the following link to activate your device:

http://activation_link/Interface/sendemail.aspx?sn=5517041123&pswd=...

Thank you!

• Please click the link to get the confirmation from the manufacturer.

Activate success.

Software downloads

• After the activation, please login the Update again, and get the APPs upgrade.

Welcome

TP39010079

.....

Login



• Please, click "Login" to download the software.

Download



CBCU DATA
V1.0 0.55MB



BOSCH DATA
V1.5 14.02MB



DELPHI DATA
V1.1 0.33MB



DENSO DATA
V1.2 1.25MB



FEUP DATA
V1.6 1.55MB



NANYUE DATA
V2.1 14MB



.....

OBD Interface

• Vehicle OBD connector locates in different part, see the picture as below:

For car:

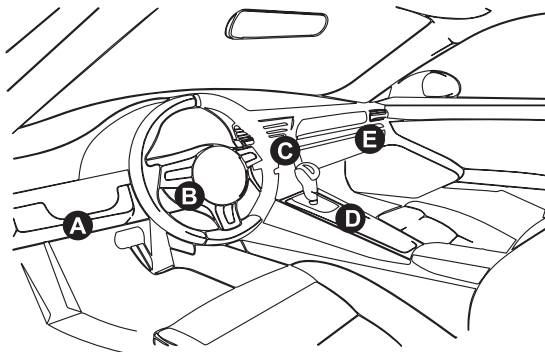

For truck:

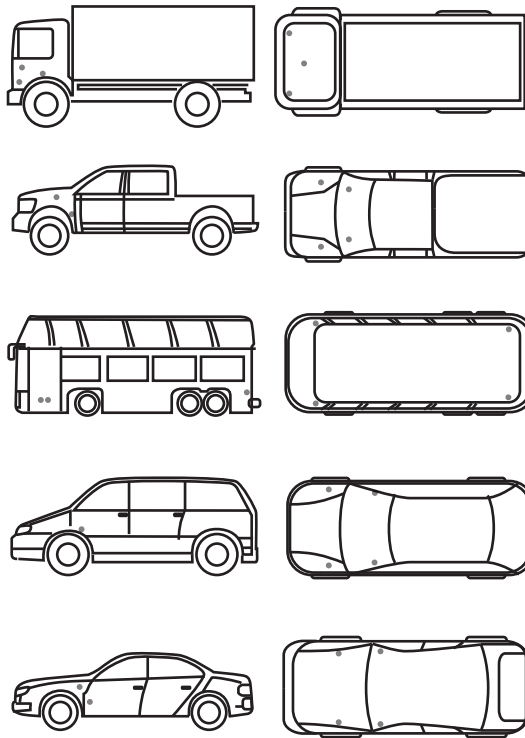

Warranty

• Two year free update and one year warranty if any quality problem during warranty time.

IDUTEX[®] Quick Start Guide TPS930 PRO

