

Product Description

Features

- Support android system, can install to any android devices which above android system 4.4.Light and small OBDII device, easy to carry.
- Can select one car maker for free from the menu.
- Plug and play through Bluetooth connection with smart phone.
- Full system with wide function coverage for each car maker update to the latest year.
- Support multiple special function software and actuation tests include Oil Service reset, ABS bleeding, IMMO & key programming, throttle body adaptation, brake pads, steering angle reset, battery matching, DPF regeneration, Injector coding.
- Multi-Language available: English, Spanish, French, Russian...etc
- One-key online update and online downloading.

VCI Specifications

Product:	PU-600
Processor:	ARM 32 - bit Cortex processor
Communications:	Bluetooth
Input Voltage:	DC 12V
Operating Temperature:	- 10 to 70 °C (14 - 158° F), Relative Humidity: <90%
Storage Temperature:	- 30 to 120°C (-22 to 248° F), Relative Humidity: <90%
Dimension:	90mm*136mm*30mm
Unit Weight:	GW: 0.14kg
Protocols:	UDS, ISO 9141-2, K/L lines, SAE-J1850VPW, SAE-J1850 PWM, CAN ISO 11898 ISO15765-4, High speed, Middle speed, low speed and Single wire CAN.

APP Guide

1. Software operating environment

- Hardware requirements: Phone with Bluetooth.
- Space disk can't less than 1G, and RAM can't less than 512M.
- Operating system: support Android above 4.4 .
- Network requirement: The software needs to be activated & downloaded online, so please make sure your internet is connected.

2. Software downloading

- **Method 1**
You can scan the QR code to download the APP
- **Method 2**
Opening the website: <http://www.idutex.com>
Home page>Support page
Then find the right software to download and install.

3. Software activation

- At first, please keep network working. Run IDUTEX APP, then click " Update " to get applications.

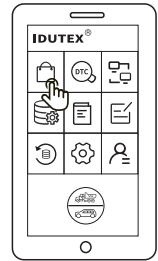

* Please input the series number and the password and then press "Login"

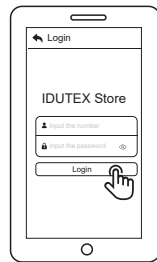

Kindly Remind:The S/N and password asked above can be found in an envelop remarked by "S/N: " characters

- If the product is not activated, please press "Yes", and input your information, the email address and country is required, and then please press "Activation".

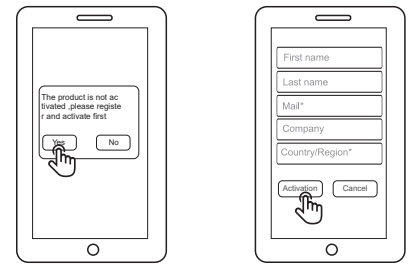

* Please be carefully select the models you need, once confirmed, it can not be changed.

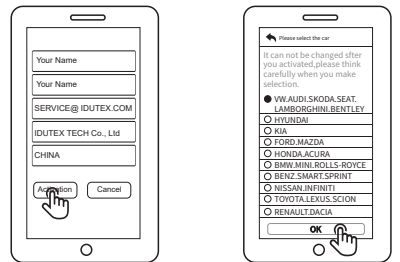

- After the information has been committed, please login your email to activate the product.

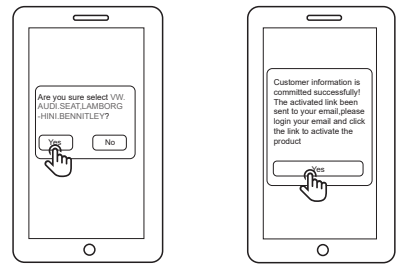

- You will receive a activated email from the IDUTEX server.

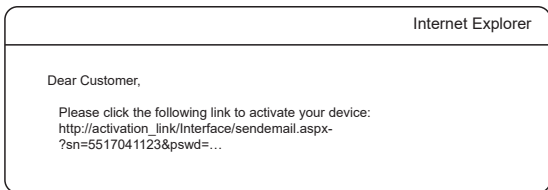

- Please click the link to get the confirmation from the manufacture.

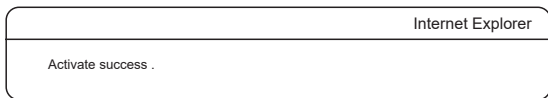

Software downloads

* After the activation, please login the Update again, and get the APPs upgrade.

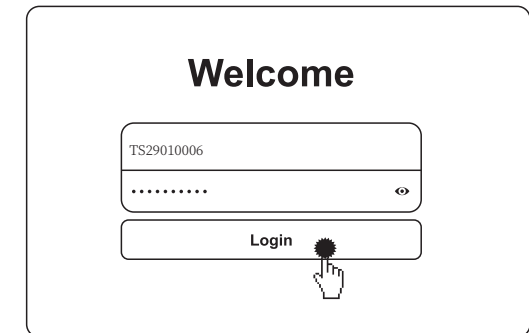

- You can download the software you need .

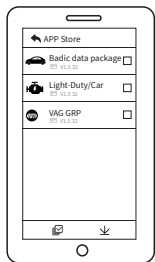

- After download , click the main button to choose vehicle to diagnose.

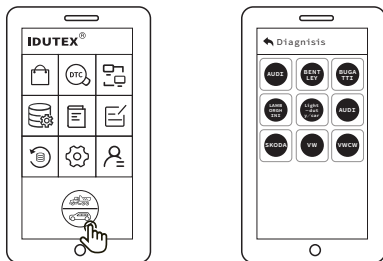

OBD Interface

- Vehicle OBD connector locates in different part, see the picture as below

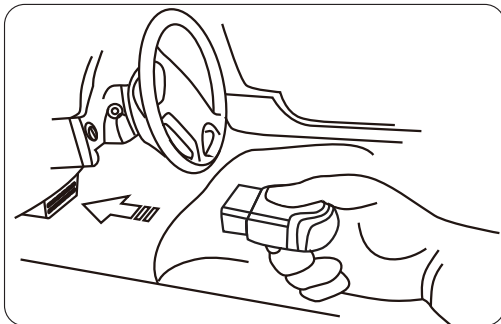
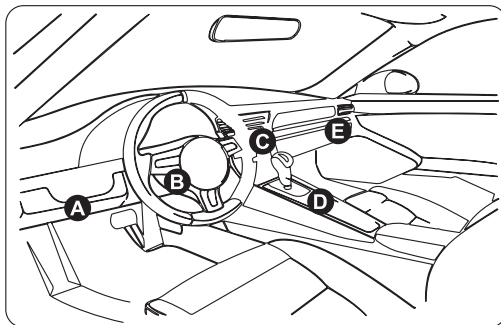

Warranty

- One year free update and one year warranty if any quality problem during warranty time.

IDUTEX® Quick Start Guide PU - 600

